

# BRExhaust™

A **MAGNAFLOW** GROUP COMPANY

## INSTALLATION INSTRUCTIONS | PART NO. 106-0415

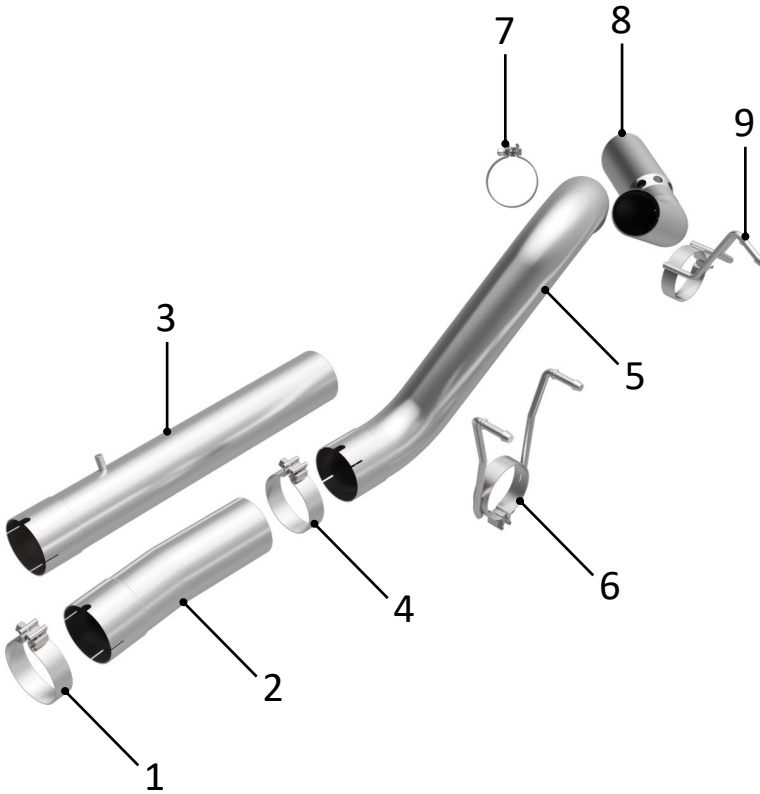

**STEP 1:** (Carefully read all instructions before installation) Disconnect the vehicle's battery before removal of the OEM exhaust system. This will prevent electrical accidents and will reset the computer if it applies to the vehicle. Remove existing exhaust system from the vehicle. Only remove parts that will be replaced. Clean existing flange with a wire brush to ensure proper sealing.

**STEP 2:** Refer to **Extension Pipes Used & Trims Required** table to determine if an extension pipe, or if any trimming of an extension pipe, is required for your vehicle configuration. Trimming of an extension pipe must be measured and performed from the pipe end without notches. All cut edges must be cleaned and deburred.

**STEP 3:** For vehicles not requiring an extension pipe slide the **[6] Hanger Clamp** over **[5] Over-Axle Assembly** with hanger barbs facing towards the front of the vehicle then attach to the DPF with supplied **[4] Clamp** making sure to align the locator notch. Attach **[6] Hanger Clamp** to existing isolators.

For vehicles requiring an extension pipe select the appropriate item **[2]** or **[3]** per the **Extension Pipes Used & Trims Required** table, perform any trimming if necessary, and attach to DPF with supplied **[1] Clamp** making sure to align the locator notch. Slide the **[6] Hanger Clamp** over **[5] Over-Axle Assembly** with hanger barbs facing towards the front of the vehicle then attach to your selected extension pipe with supplied **[4] Clamp**.

**STEP 4:** Slide the **[9] Hanger Clamp** over **[8] Tailpipe Assembly** then attach to **[5] Over-Axle Assembly** with supplied **[7] Clamp**. Attach **[9] Hanger Clamp** to existing isolator.

**STEP 5:** For 2013 and later vehicles with a Long Bed that use **[3] Extension Pipe** attach the OEM cable bracket reusing existing hardware.

**STEP 6:** Tighten all clamps and bolts starting from rear of the vehicle. **(DO NOT EXCEED 30FT-LB WHEN TIGHTENING CLAMP AND CHECK ALL CLAMPS AFTER 50 MILES. RETIGHTEN IF NECESSARY)**

Extension Pipes Used & Trims Required			Item
2013 And Later	Crew Cab/Short Bed	No Extension Used	N/A
	Crew Cab/Long Bed	Trim 3.25in.	3
	Mega Cab/Short Bed	No Trim Required	2
2007.5 - 2012	Crew Cab/Short Bed	Trim 16.75in.	3
	Crew Cab/Long Bed	No Extension Used	N/A
	Mega Cab/Short Bed	Trim 11in.	3

### WARNING:

When working on, under, or around any vehicle exercise caution. Please allow the vehicle's exhaust system to cool before removal, as exhaust temperatures may cause severe burns. If working without a lift, always consult vehicle manual for correct lifting specifications. Always wear safety glasses and ensure a safe work area. Serious injury or death could occur if safety measures are not followed.



**BRExhaust** recommends professional installation for all products

**Technical Support: 1-800-631-7271**

**BRExhaust — 1901 Corporate Ctr, Oceanside, CA 92056**

[www.brexhaust.com](http://www.brexhaust.com)