

BRExhaust™

A **MAGNAFLOW** GROUP COMPANY

INSTALLATION INSTRUCTIONS | PART NO. 106-0344

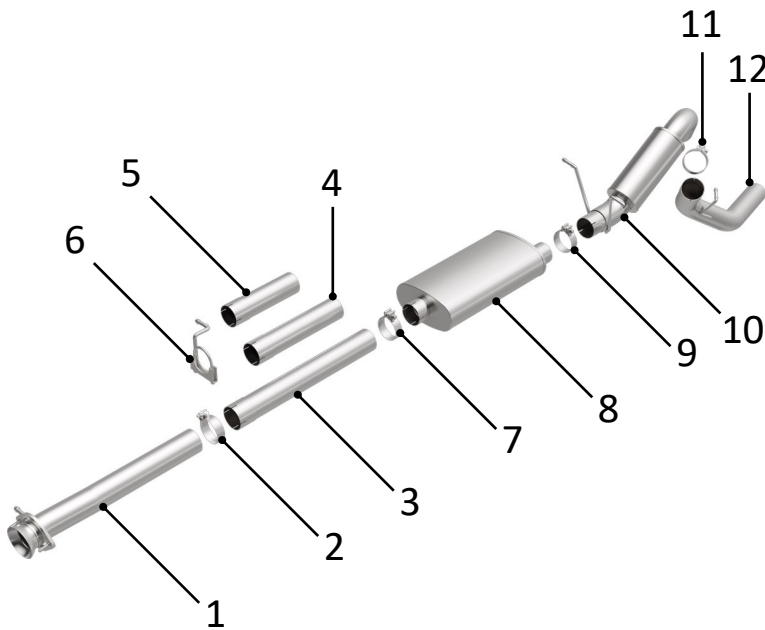

WARNING:

When working on, under, or around any vehicle exercise caution. Please allow the vehicle's exhaust system to cool before removal, as exhaust temperatures may cause severe burns. If working without a lift, always consult vehicle manual for correct lifting specifications. Always wear safety glasses and ensure a safe work area. Serious injury or death could occur if safety measures are not followed.

STEP 1: (Carefully read all instructions before installation) Disconnect the vehicle's battery before removal of the OEM exhaust system. This will prevent electrical accidents and will reset the computer if it applies to the vehicle. Remove existing exhaust system from the vehicle. Only remove parts that will be replaced. Clean existing flange with a wire brush to ensure proper sealing.

STEP 2: [1] Inlet Pipe Assembly & Extension Pipe configurations;

For Standard Cab Long Bed vehicles trim 10in. from the outlet end of [1] Inlet Pipe Assembly then attach to existing isolator and exhaust using existing hardware.

For Extended Cab Short Bed vehicles attach [1] Inlet Pipe Assembly to existing isolator and exhaust using existing hardware and supplied [6] Hanger Clamp.

For Crew Cab Short Bed vehicles attach [1] Inlet Pipe Assembly to existing isolator and exhaust using existing hardware and supplied [6] Hanger Clamp then attach 13in. [5] Extension Pipe to [1] Inlet Pipe Assembly with supplied [2] Clamp.

For Extended Cab Long Bed vehicles attach [1] Inlet Pipe Assembly to existing isolator and exhaust using existing hardware and supplied [6] Hanger Clamp then attach 17in. [4] Extension Pipe to [1] Inlet Pipe Assembly with supplied [2] Clamp.

For Crew Cab Long Bed vehicles attach [1] Inlet Pipe Assembly to existing isolator and exhaust using existing hardware and supplied [6] Hanger Clamp then attach 26.5in. [3] Extension Pipe to [1] Inlet Pipe Assembly with supplied [2] Clamp.

STEP 3: Attach [8] Muffler to selected [1] Inlet Pipe Assembly & Extension Pipe configuration with supplied [7] Clamp.

STEP 4: Attach [10] Over-Axle Pipe Assembly to existing isolators and [8] Muffler with supplied [9] Clamp.

STEP 5: Attach [12] Tailpipe Assembly to existing isolator and [10] Over-Axle Pipe Assembly with supplied [11] Clamp.

STEP 6: Ensure new exhaust is not contacting any portion of the underbody of the vehicle or drivetrain.

STEP 7: Tighten all clamps and bolts starting from rear of the vehicle. (DO NOT EXCEED 30FT-LB WHEN TIGHTENING CLAMP AND CHECK ALL CLAMPS AFTER 50 MILES. RETIGHTEN IF NECESSARY)



BRExhaust recommends professional installation for all products

Technical Support: 1-800-631-7271

BRExhaust — 1901 Corporate Ctr, Oceanside, CA 92056

www.brexhaust.com